

# **East Kent Access Phase 2**

**Geoff Cripps**

**Major Projects Manager**

Kent County Council

Highways & Transportation

**Proposals for Traffic Management and  
Traffic Calming Measures along the Former  
A299 and A256 Primary Routes**

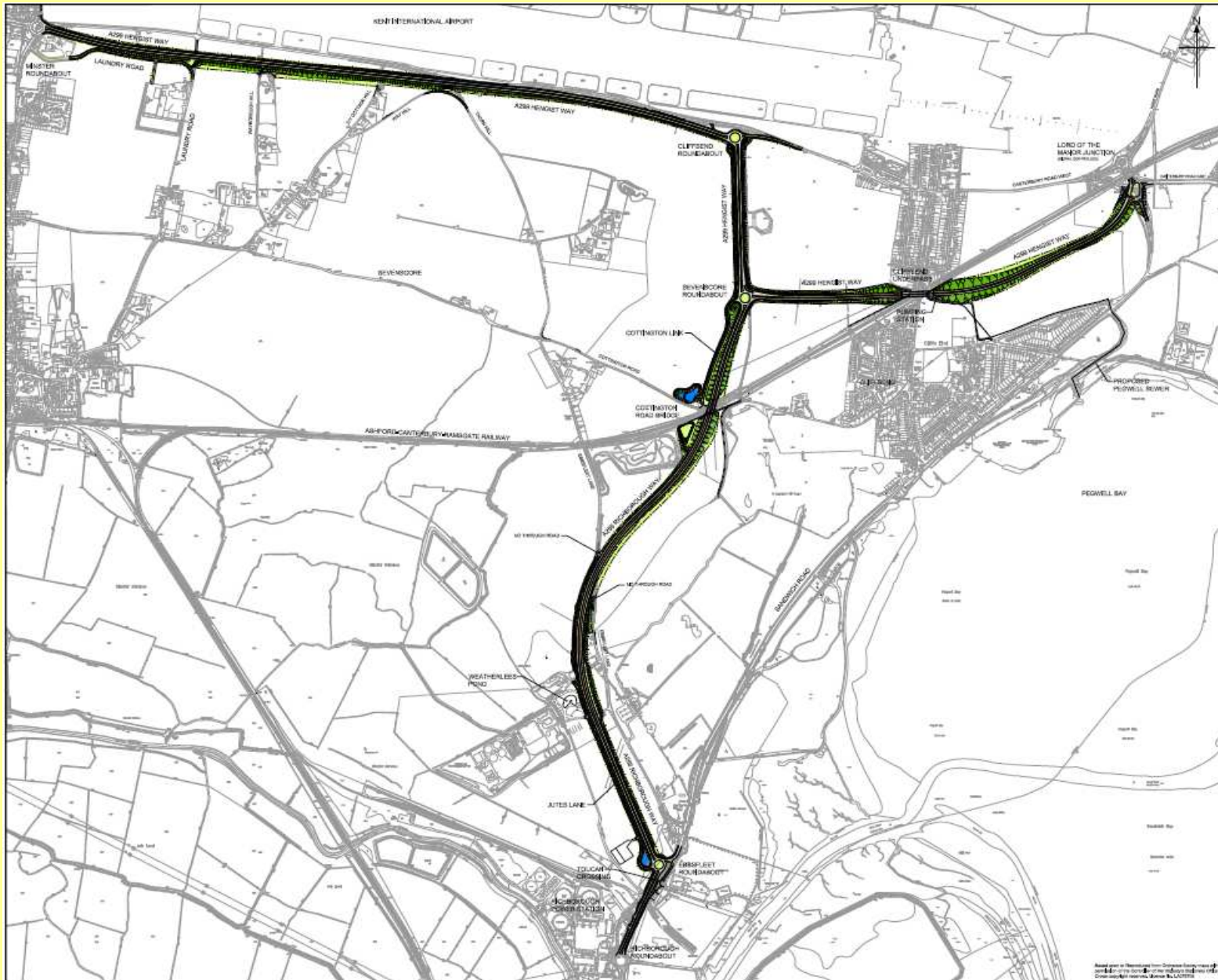

331700/000/17

**KEY**

- Delimited construction
- Verge / Landscape area
- Watercourse / Landscape bund
- Footway, cycleway and central reserves
- Drainage system

17	18	19	20	21	22	23	24	25	26	27	28	29	30	31	32	33	34	35	36	37	38	39	40	41	42	43	44	45	46	47	48	49	50	51	52	53	54	55	56	57	58	59	60	61	62	63	64	65	66	67	68	69	70	71	72	73	74	75	76	77	78	79	80	81	82	83	84	85	86	87	88	89	90	91	92	93	94	95	96	97	98	99	100
----	----	----	----	----	----	----	----	----	----	----	----	----	----	----	----	----	----	----	----	----	----	----	----	----	----	----	----	----	----	----	----	----	----	----	----	----	----	----	----	----	----	----	----	----	----	----	----	----	----	----	----	----	----	----	----	----	----	----	----	----	----	----	----	----	----	----	----	----	----	----	----	----	----	----	----	----	----	----	----	----	----	----	-----

**Kent**

**JACOBS**

East Kent Access  
PHASE 2

GENERAL LAYOUT

FOR INFORMATION

NOT TO SCALE | Do not scale

331700/000/17

D

# Local Road Speed Restrictions

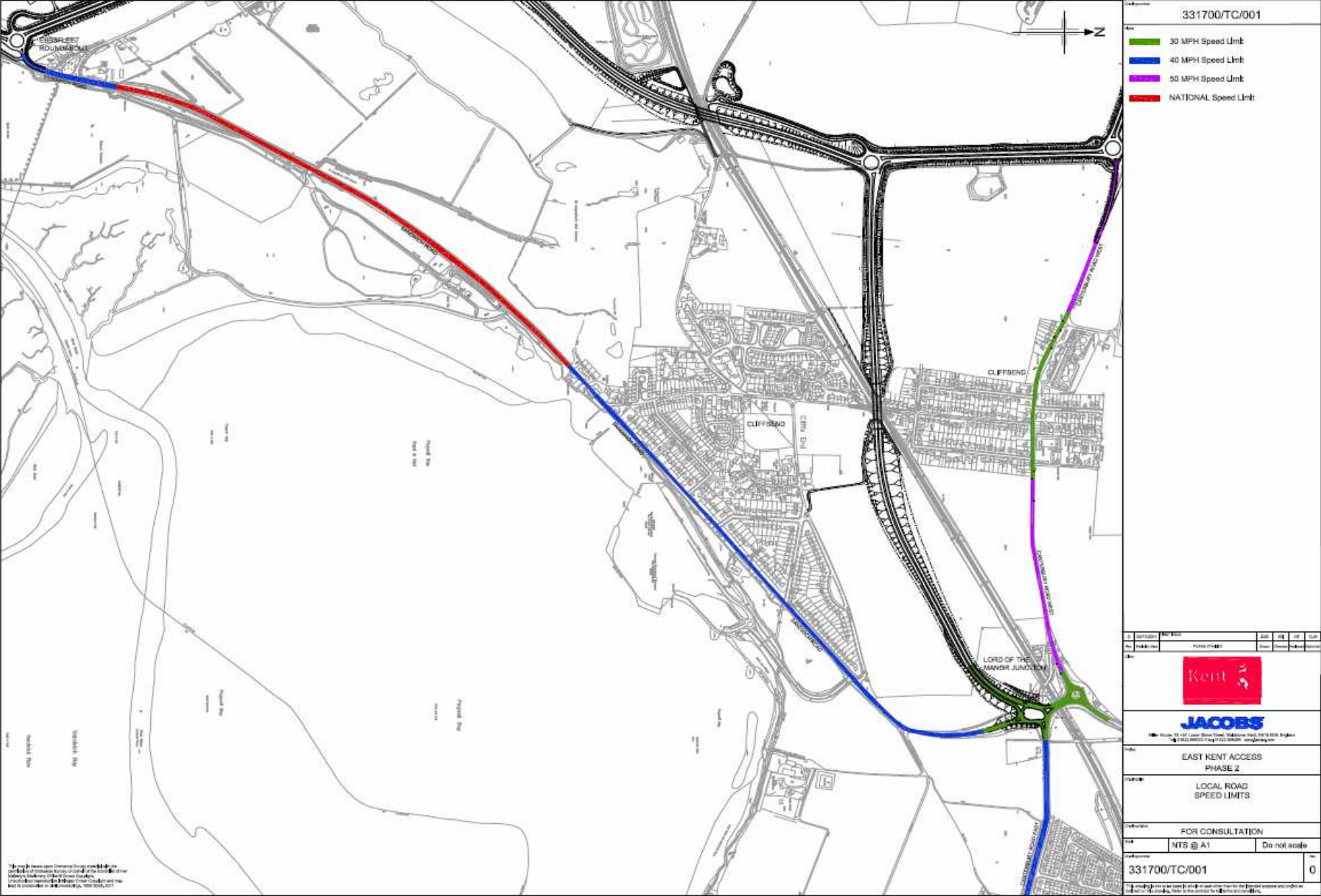



# Proposed Traffic Calming Along A299 Through Cliffsend (North)

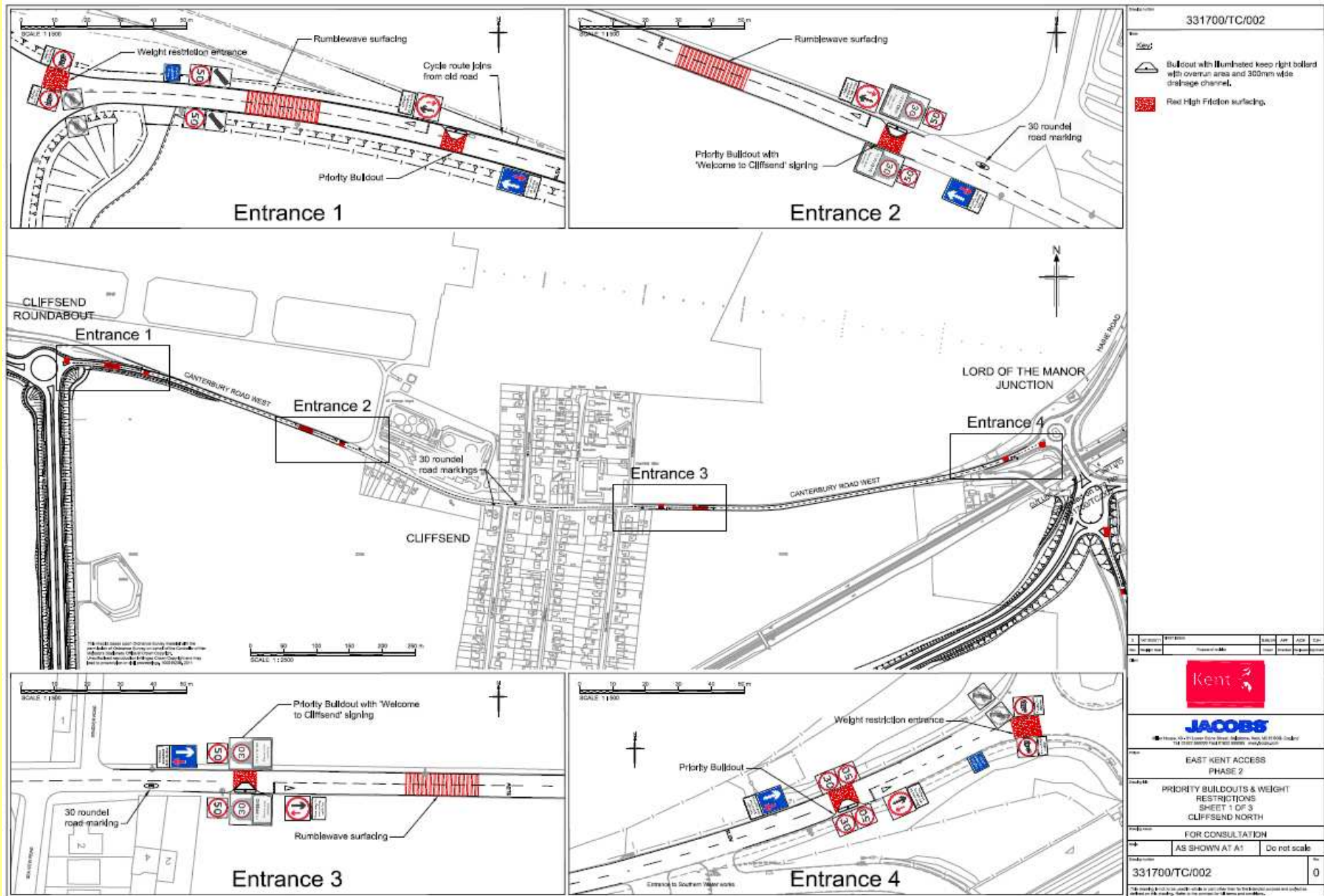

331700/TC/002

- Key:**
- Bulbout with illuminated keep right bollard with overrun area and 300mm wide drainage channel.
  - Red High Friction surfacing.

Entrance 1

Entrance 2

CLIFFSEND ROUNDABOUT

Entrance 1

Entrance 2

Entrance 3

LORD OF THE MANOR JUNCTION

Entrance 4

CLIFFSEND

SCALE 1:2500

SCALE 1:2500

SCALE 1:1500

Entrance 3

Entrance 4



**JACOBS**

EAST KENT ACCESS PHASE 2

PRIORITY BULBOUTS & WEIGHT RESTRICTIONS SHEET 1 OF 3 CLIFFSEND NORTH

FOR CONSULTATION

AS SHOWN AT A1 Do not scale

331700/TC/002

0





# Proposed Traffic Calming Along A256 Near Ebbsfleet

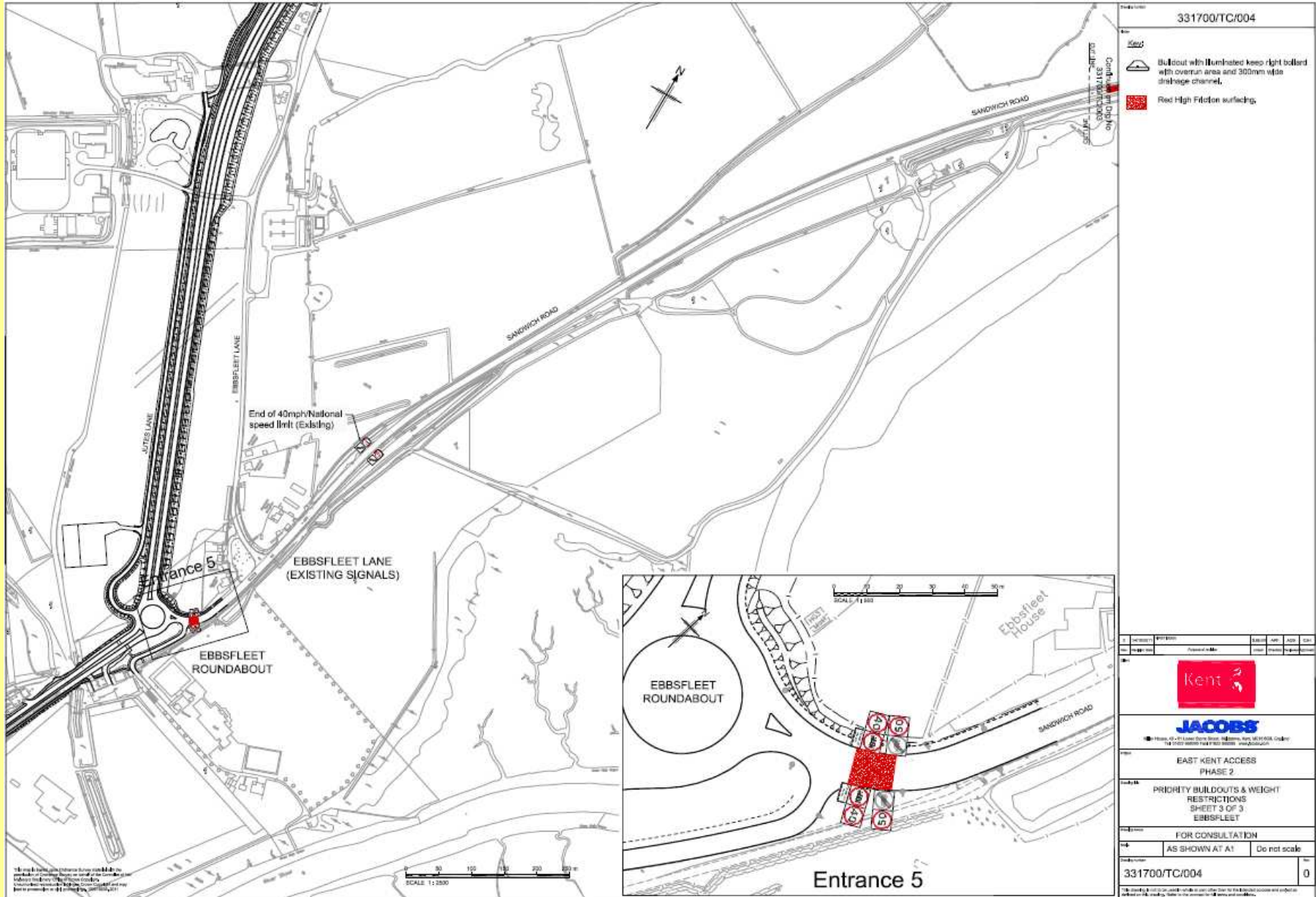

331700/TC/004

	Bollout with illuminated keep right bollard with overrun area and 300mm wide drainage channel.
	Red High Friction surfacing.

Author	PR/004	Checked	AM	Date	
Design		Reviewed	AM	Date	



EAST KENT ACCESS  
PHASE 2

PRIORITY BOLLOUTS & WEIGHT  
RESTRICTIONS  
SHEET 3 OF 3  
EBBSFLEET

FOR CONSULTATION  
AS SHOWN AT A1 Do not scale

Project Number	331700/TC/004	Rev	0
----------------	---------------	-----	---

This drawing is the property of Jacobs and shall not be reproduced or copied in any form without the written consent of Jacobs. It is to be used only for the project and site for which it is prepared. It is not to be used for any other project or site. Jacobs and its consultants accept no liability for any errors or omissions in this drawing. Jacobs and its consultants are not responsible for any delays or costs incurred by the client as a result of any errors or omissions in this drawing.

Thank you for listening

.....any Questions

